

Resolution # 2022-06

A RESOLUTION TO SUPPORT THE DESIGNATION OF THE MISSISSIPPI RIVER TRAIL WITHIN THE LIMITS OF the VILLAGE OF COCHRANE

WHEREAS bicycle tourism is a growing industry in North America, contributing \$47 billion a year to the economies of communities that provide facilities for such tourists; and

WHEREAS the Mississippi River Trail is a national bicycle route, along the length of the Mississippi River, through ten states, from the headwaters at Lake Itasca to the Gulf of Mexico; and

WHEREAS the Mississippi River Trail was designated as one of only 16 National Millennium Trails which honor the past and imagine the future by preserving and commemorating major events and aspects of America's history and culture; and

WHEREAS the Mississippi River Trail provides access to and promotes the scenic, historic, archaeological, cultural, recreational and natural qualities of the Mississippi River and its amenities; and

WHEREAS the Mississippi River Trail is located primarily on the Wisconsin All-American Great River Road National Scenic Byway (WIS 35) between Prescott and Illinois State Line, but also routed on other state and county highways, local roads or alternative routes for bicycling; and

WHEREAS the Wisconsin Mississippi River Parkway Commission and the Village of Cochrane, with the cooperation of the Wisconsin Department of Transportation, Wisconsin Department of Natural Resources and other stakeholders, have proposed a specific route to be designated as Mississippi River Trail; and

WHEREAS the Mississippi River Trail implements Wisconsin Statutes Chapters 1.11, 84.01(35), 84.60, and 85.02, 349.23 and Wisconsin Administrative Code Chapter Trans 400 which required that "due consideration to establishing bikeways and pedestrian ways in all new highway construction and reconstruction projects"; and

WHEREAS the Mississippi River Trail adds value to existing roads and trails; and

WHEREAS the Mississippi River Trail is largely ready to sign and market, and many suggested improvements are already planned; and

WHEREAS the Mississippi River Trail will contribute to sustainable economic development in 33 Wisconsin Mississippi River communities; and

WHEREAS the proposed route for the Mississippi River Trail comes through the Village of Cochrane and can therefore provide a benefit to our residents and businesses; and

WHEREAS the Mississippi River Trail will provide increased recreational and transportation choices for individuals to enjoy the outdoors as well as provide health, economic, and quality of life benefits; and

WHEREAS the Mississippi River Trail continues Wisconsin's tradition of honoring and enhancing the Mississippi River by offering multiple bicycling experiences, each in a unique river landscape; and

WHEREAS we have investigated the proposed route and found it to be a suitable route, and desire that the route be designated so that it can be mapped and signed, thereby promoting bicycle tourism in our area; and

THEREFORE, BE IT RESOLVED, that the Village of Cochrane in order to receive full benefit of the Mississippi River Trail, hereby expresses its approval and support for the development of the Mississippi River Trail, and requests that the appropriate officials see to it that the route is officially designated along the following segments near the limits of the Village of Cochrane:

SOUTHBOUND: Entering the Village of Cochrane on County Trunk Highway (CTH) OO from south village limits north to the intersection with CTH O/Wisconsin Street, turn right and continue east on CTH O/Wisconsin Street to the intersection with WIS 35, turn right and continue south on WIS 35 to south village limits.

NORTHBOUND: Entering the Village of Cochrane on WIS 35 from south village limits north to the intersection with CTH O/Wisconsin Street, turn left and continue west on CTH O/Wisconsin Street to the intersection with CTH OO, turn left and continue south on CTH OO to south village limits.

(See attached maps)

Dated this 9th day of November, 2022.

Dave Busch, Village President

ATTEST:

Carrie Venner-Adams, Village Clerk

STATE OF WISCONSIN
WISCONSIN DEPARTMENT OF TRANSPORTATION

06-111

DATE	MILEAGE FOR LOCAL ROADS/STREETS	LOCAL ROADS/STREETS Certified in accordance with sec. 86.30 Wis. stat.	
(1) 4-1-20	4.35		
(2) 1-1-21	.	Name:	Title:
(3) 4-1-21	.	Signature:	Date:

VILLAGE OF
COCHRANE
COUNTY: BUFFALO

- (1) THIS DATA REPRESENTS THE LAST CERTIFIED MILEAGE AS CORRECTED BY WISDOT WHICH MAY HAVE BEEN USED FOR PAST TRANSPORTATION AIDS.
- (2) THE TOWN CHAIRMAN OR CITY/VILLAGE CLERK IS TO FILL IN THE MILEAGE TO BE CERTIFIED AS OPEN TO THE PUBLIC AS OF THE FOLLOWING JANUARY, INCLUDING THE NEW CHANGES THAT ARE MADE ON THE PLAT.
- (3) THIS DATA REPRESENTS MILEAGE ADJUSTMENTS MADE BY WISDOT DUE TO FIELD VERIFICATION, INVENTORY, ANNEXATION, ETC. TRANSPORTATION AID PAYMENTS MAY BE MADE BASED ON THIS FIGURE.

MILEAGE FOR COUNTY TRUNKS	MILEAGE FOR COUNTY OTHER ROADS
0.79	00.00

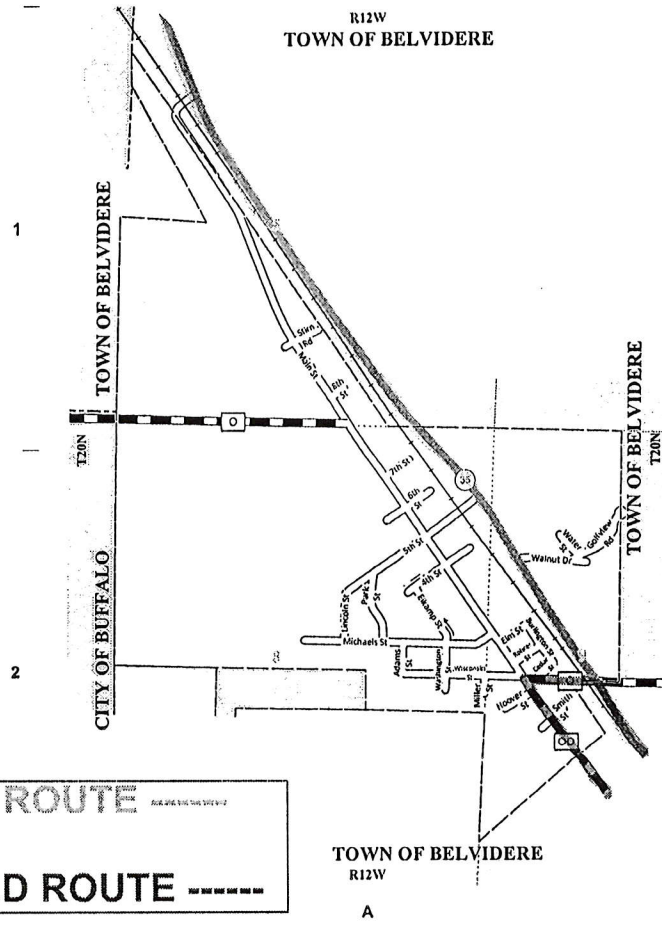

LEGEND:

- County Trunk Highway
- CVT Border
- Local Road
- PLSS Border
- State Trunk
- Railroad

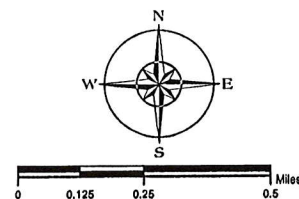

The information contained on this map was created for the official use of the Wisconsin Department of Transportation (WisDOT). Any other use while not prohibited, is the sole responsibility of the user. WisDOT expressly disclaims all liability regarding fitness of use of the information for other than official WisDOT business.